



900 N OCEAN

POMPAÑO BEACH, FLORIDA

OWNER:

PRH 900 NORTH OCEAN, LLC

ARQUITECTONICA

2900 Oak Avenue  
Miami, Florida 33133  
Tel: (305) 372-1612  
www.arquitectonica.com



301 E Atlantic Blvd.  
Pompano Beach, Florida 33060  
Tel: (954) 788-3400  
www.keithteam.com

STRUCTURAL ENGINEER:  
TBD.

MEP ENGINEER:  
TBD.



2900 Oak Avenue  
Miami, Florida 33133  
Tel: (305) 372-1612  
www.arquitectonica.com

SEAL/SIGNATURE/DATE:

Alejandro Javier Perez  
Digitally signed by Alejandro Javier Perez  
Date: 2021.05.28 11:18:29 -04'00'

DRC SUBMITTAL

28 APRIL, 2021

| ISSUE # | DESCRIPTION | DATE       |
|---------|-------------|------------|
| 01      | PRE-APP     | 01/27/2021 |
| 02      | DRC         | 03/18/2021 |
| 03      | DRC         | 05/26/2021 |

PROJECT NUMBER:

ALL DESIGNS INDICATED IN THESE DRAWINGS ARE THE PROPERTY OF ARQUITECTONICA INTERNATIONAL CORP. ALL COPYRIGHTS RESERVED 2021. NO COPIES, TRANSMISSIONS, REPRODUCTIONS OR ELECTRONIC MANIPULATION OF ANY PORTION OF THESE DRAWINGS IN WHOLE OR IN PART ARE TO BE MADE WITHOUT THE EXPRESS WRITTEN PERMISSION OF ARQUITECTONICA INTERNATIONAL CORP.

DRAWING NAME:

LANDSCAPE CALCULATIONS

L9-002

PZZ-1-0000  
7/28/2021

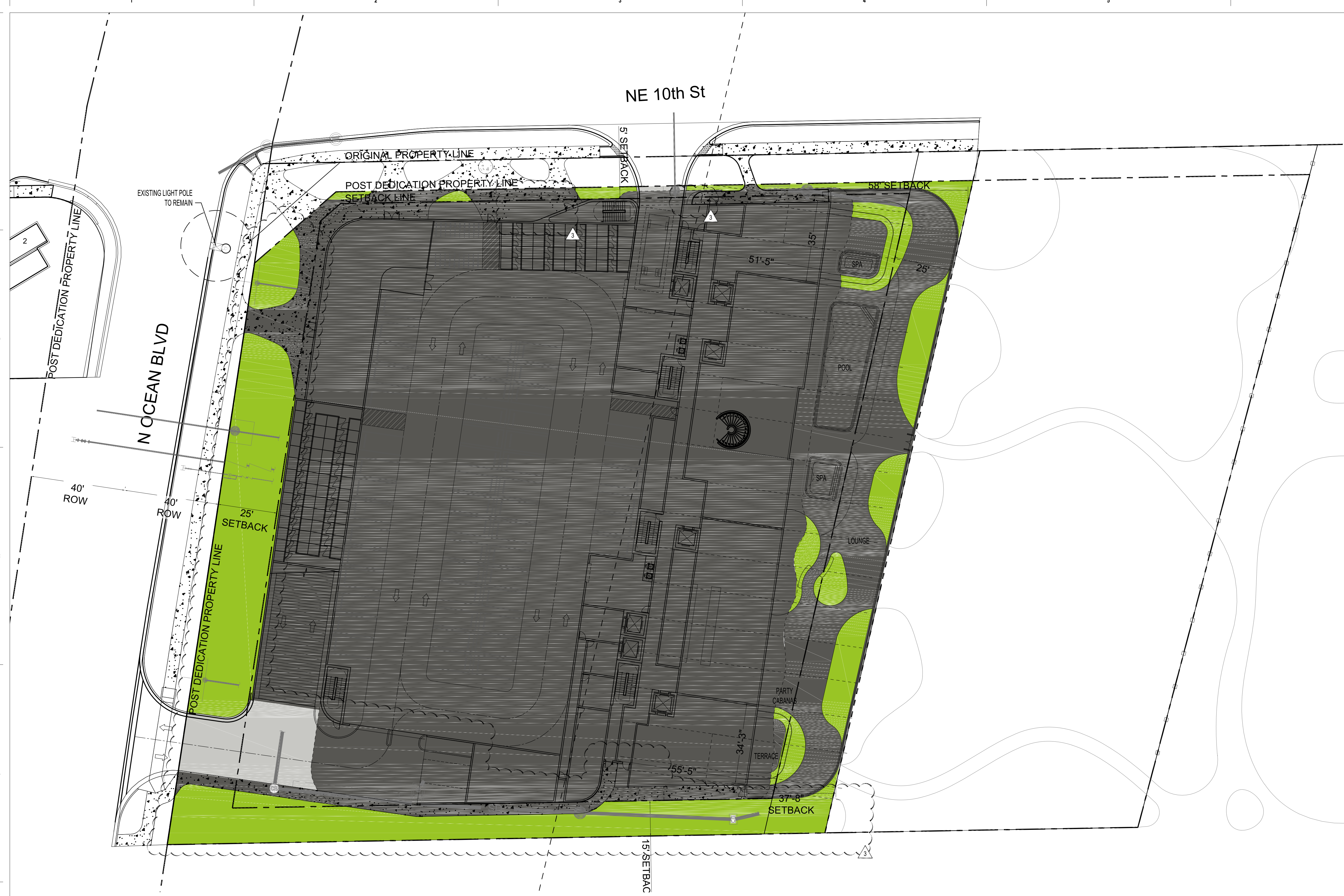

| LANDSCAPE AREAS SCHEDULE |                    |           |            |
|--------------------------|--------------------|-----------|------------|
| SYMBOL                   | DESCRIPTION        | QTY       | PERCENTAGE |
| 1-PA                     | Pervious Area      | 12,258 sf | 15 %       |
| 2-IA                     | Impervious Area    | 65,194 sf | 83 %       |
| 3-VA                     | Vehicular Use Area | 1,608 sf  | 2 %        |

| LANDSCAPE AREAS SCHEDULE (INCLUDING DUNES) |                    |           |            |
|--|--------------------|-----------|------------|
| SYMBOL                                     | DESCRIPTION        | QTY       | PERCENTAGE |
| 1-PA                                       | Pervious Area      | 51,861 sf | 43 %       |
| 2-IA                                       | Impervious Area    | 65,194 sf | 55 %       |
| 3-VA                                       | Vehicular Use Area | 1,608 sf  | 2 %        |